

A/19074/454/95
Planning Permit No. **APPROVED**
SUBJECT TO THE CONDITIONS IN THIS OFFICE LETTER.
No. A/16151/95 DATE: -7-95
FOR MEMORANDUM SECRETARY
PRO. WELL & S. TANK
MADRAS 600 008.

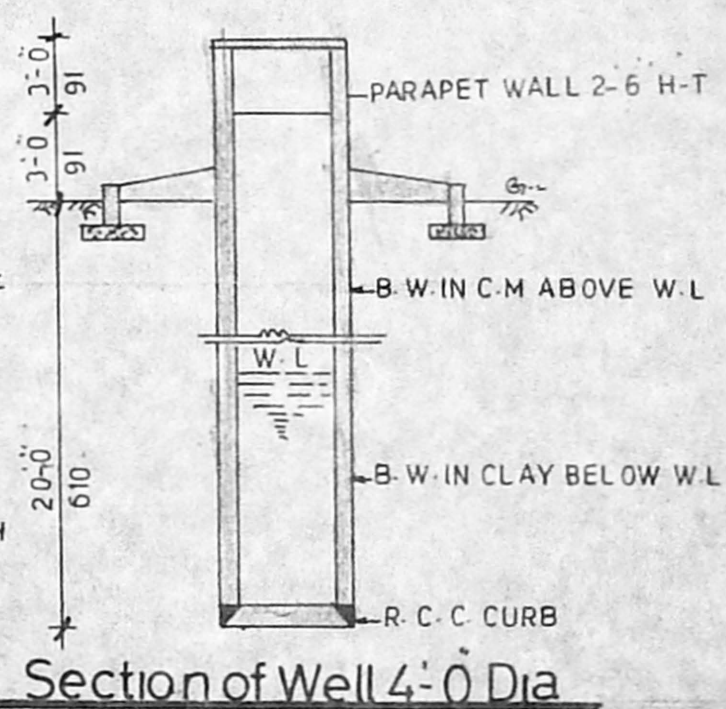
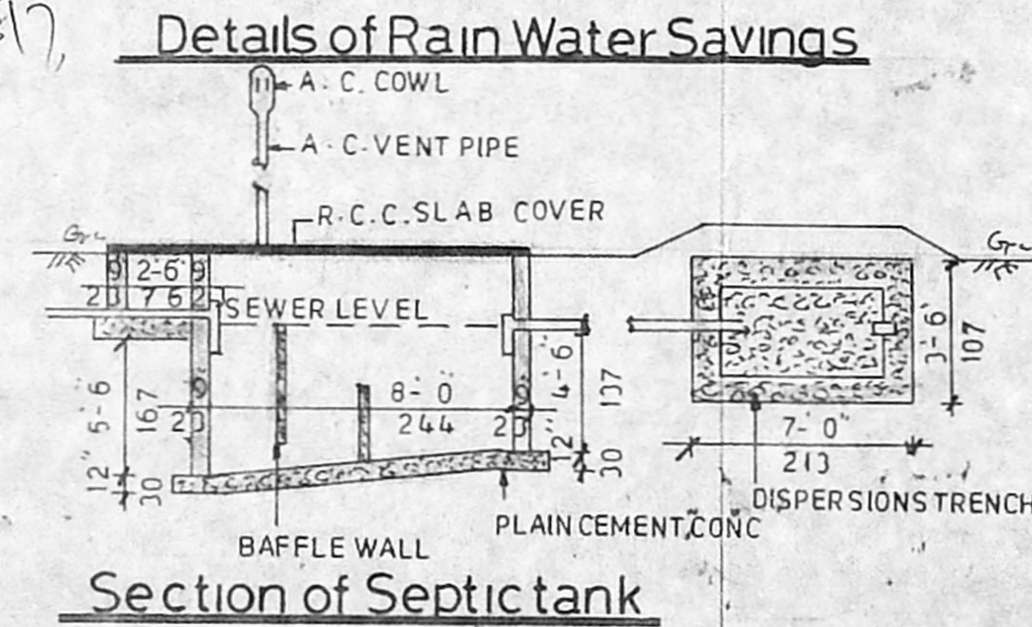
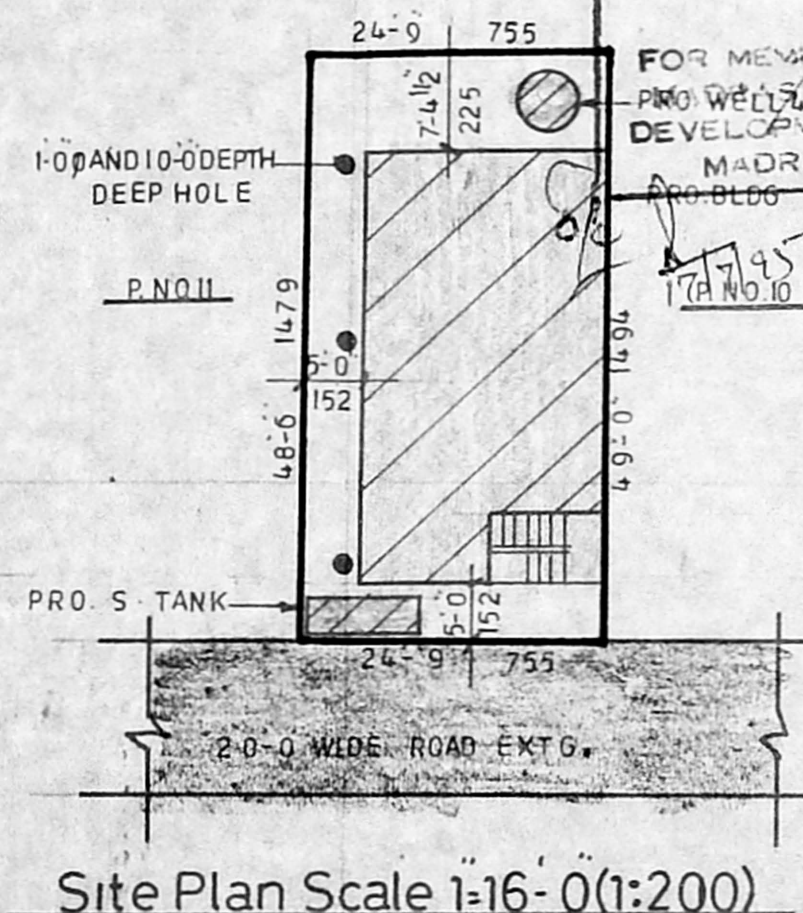
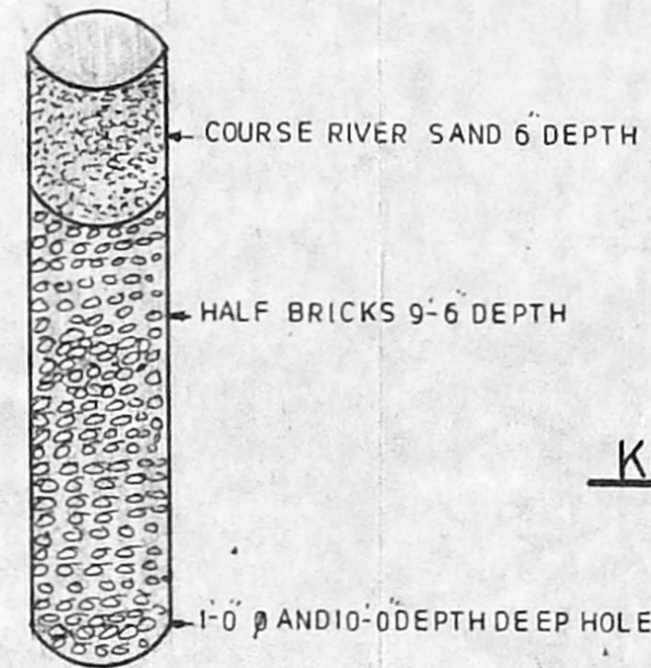

PLAN SHOWING THE PROPOSED BLDG. AT
P. NO. 10a, RAMACHANDRA PILLAI AVENUE IN
S. NO. 279/2 OF POZHICHALUR VILLAGE,
ST-THOMAS MOUNT PANCHAYAT LIMIT, SAIDAPET
TALUK FOR Mr. N. Ramesh.

JOINERY	DETAILS	EXTENT	SQ. FT	SQ. M
D. DOOR	3-3 X 7-0 99 X 213	PLOT	1206-00	112-00
Q. DOOR	3-0 X 7-0 91 X 213			
Q. DOOR	2-6 X 7-0 76 X 213			
W. WINDOW	4-6 X 4-6 137 X 137	PRO. BLDG.	663-00	61-60
W. WINDOW	3-0 X 4-6 91 X 137	PLOT COVERAGE	54-98%	
V. VENTILATOR	3-0 X 2-0 91 X 61	F. S. I.	0-55	
G. GRILL	4-0 X 4-0 122 X 122	GD GRILL DOOR	3-3 X 7-0 99 X 213	

COLOUR	INDEX
EXISTINGS	PARALLEL
PROPOSALS	
ROADS	
SITE BOUNDRY	NO. 118, FIRST FLOOR, KARUNEEGAR STREET, ADAMBAKKAM, MADRAS. 88.
STAIR CASE DETAILS	
WIDTH	3'-0" 91 CM
TREAD	0'-10" 25 CM
RISE	0'-7" 18 CM

PARALLEL
NO. 118, FIRST FLOOR,
KARUNEEGAR STREET,
ADAMBAKKAM, MADRAS. 88.
JOB. NO. 05/0494 DRG. NO. 556
DATE 11-4-94
SCALE 1:8'-0" (1:100)
DRN. BY. C. LAKSHMANAN

(Signature)
SIGN OF OWNER
(Signature)
P. GANESAN, D.C.E.
LICENSED SURVEYOR,
AMBATTUR AND ALANDUR MUNICIPALITY
PARALLEL BUILDERS
CONSULTING ENGINEERS AND CONSTRUCTORS
LINE 580 Opp. Karuneeagar St,
Adambakkam, Madras-88.